

EXPO
INOX

ALUTEK



ALUTEK

ALLUMINIO BIANCO

WHITE ALUMINUM



SISTEMA MONOPARETE ALUTEK

Il sistema **monoparete ALUTEK** è composto da elementi componibili rigidi monoparete, realizzati in alluminio smaltato bianco di spessore minimo 1 mm. Viene utilizzato come canale da fumo o come condotto di adduzione dell'aria comburente del generatore, secondo la normativa EN 1856-2. Gli elementi modulari hanno innesto classico a bicchiere maschio-femmina calibrato con guarnizione di tenuta a triplice labbro, conforme alla normativa europea EN 14241-1. Il sistema è adatto a ricevere i fumi con temperatura massima di esercizio fino a 200 °C.

Riferimento normativo e designazione

Marcatura prodotto secondo normativa europea EN 1856-2.
T200 H1 W VM L13100 O 60 - spessore 1 mm

Utilizzo

Condotti, canali da fumo, camini metallici, esalazioni aria asserviti a generatori di calore di tipo atmosferico, pressurizzato, ad aria soffiata tradizionali, cappe cucina per uso domestico.

Applicazione

Installazione interna.

Diametri disponibili - mm

80

Guarnizione in silicone compresa e montata.

SINGLE WALL ALUTEK SYSTEM

Single wall ALUTEK system is composed by single wall modular rigid elements, made of white enamelled aluminum with a minimum thickness of 1 mm. It is used as a flue pipe or to combustion air supply of the generator, according to the standards set out by the European CE mark, EN 1856-2. The modular elements have classic male-female junction calibrated with triple seal lip gasket, conforming to European standard EN 14241-1.

The system is suitable to receive flue gases with a maximum operating temperature of 200 °C.

Normative references and designation

*Product marking according to the European standard EN 1856-2.
T200 H1 W VM L13100 O 60 - thickness 1 mm*

Utilizations

Ducts, flue pipes, metal chimneys, air conduction subservient to atmospheric heat generators, pressurized, air blown traditional, domestic kitchen hoods.

Application

Internal installation.

Available diameters - mm

80

All the items are complete of silicone seal.

ALLUMINIO BIANCO - WHITE ALUMINUM



ALUTA20S...

Elemento lineare da 2 m.

Pipe 2 m.



ALUTA1S...

Elemento lineare da 1 m.

Pipe 1 m.



ALUTA5S...

Elemento lineare da 0,50 m.

Pipe 0.50 m.

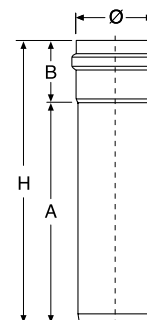
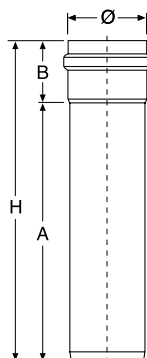
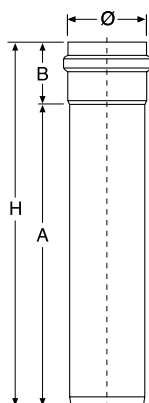

Ø	COD.	A	B	H	PCS
80	ALUTA20S08	1947	50	1997	10

Ø	COD.	A	B	H	PCS
80	ALUTA1S08	944	50	994	10

Ø	COD.	A	B	H	PCS
80	ALUTA5S08	445	50	495	10

Ø 60 a richiesta
Ø 60 on request

Colorazione nera a richiesta
Black color on request



ALUTA2S...

Elemento lineare da 0,25 m.

Pipe 0.25 m.

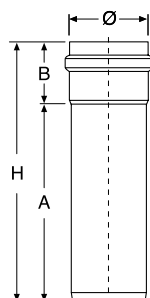

Ø	COD.	A	B	H	PCS
80	ALUTA2S08	195	50	245	10



ALUGA90X...

Curva a 90° M/F.

Elbow 90° M/F.

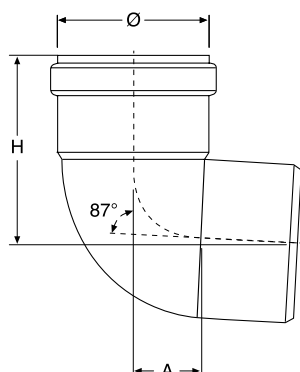

Ø	COD.	A	H	PCS
80	ALUGA90X08	40	95	10



ALUGA45X...

Curva a 45° M/F.

45° tee M/F.

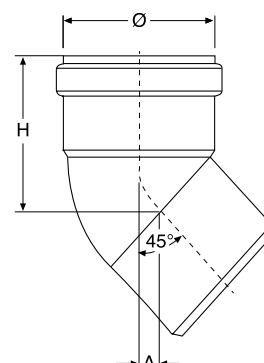

Ø	COD.	A	H	PCS
80	ALUGA45X08	20	80	10

Ø 60 a richiesta
Ø 60 on request

Colorazione nera a richiesta
Black color on request

ALLUMINIO BIANCO - WHITE ALUMINUM



ALUGA90FF...

Curva a 90° F/F.

Elbow 90° F/F.



ALUGA45FF...

Curva a 45° F/F.

45° tee F/F.



ALUT69SCS...

Raccordo a "T" 90° con scarico condensa.

90° tee with condense drain.

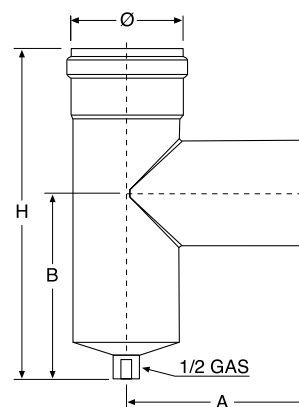
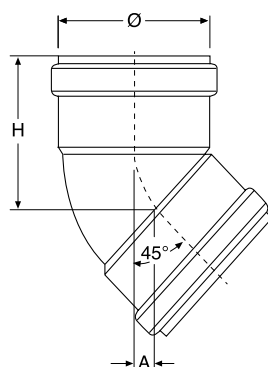
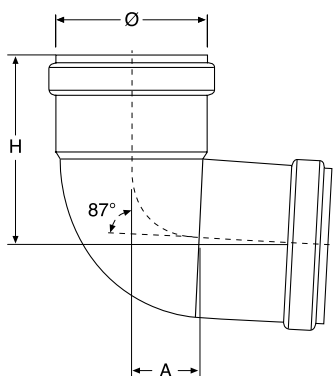

Ø	COD.	A	H	PCS
80	ALUGA90FF08	40	93	10

Ø	COD.	A	H	PCS
80	ALUGA45FF08	15	80	10

Ø	COD.	A	B	H	PCS
80	ALUT69SCS08	140	140	250	4

Ø 60 a richiesta
Ø 60 on request

Colorazione nera a richiesta
Black color on request



ALURCV...

Raccogli condensa verticale.

Vertical collect condens.



ALURCO...

Raccogli condensa orizzontale.

Horizontal collect condens.



ALUPF...

Elemento per prelievo fumi.

Fumes test section with threaded sleeve.

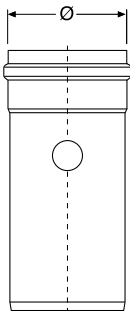

Ø	COD.	PCS
80	ALURCV08	10

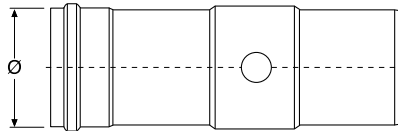

Ø	COD.	PCS
80	ALURCO08	10

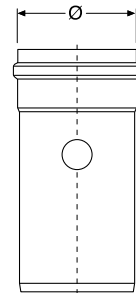

Ø	COD.	PCS
80	ALUPF08	10

Ø 60 a richiesta
Ø 60 on request

Colorazione nera a richiesta
Black color on request

ALLUMINIO BIANCO - WHITE ALUMINUM



ALUMMA...

Manicotto femmina - femmina.

Double female adaptor.



L316EXSCAFUM...

Terminale in acciaio inox per scarico fumi.

Stainless steel terminal for smoke exhaust.



L316EXGASP...

Griglia in acciaio inox per aspirazione.

Stainless steel grill for aspiration.

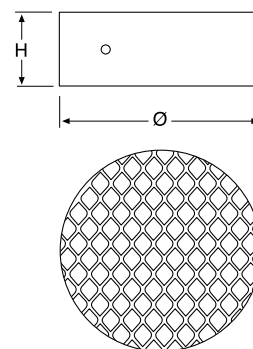
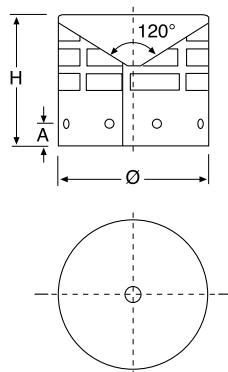
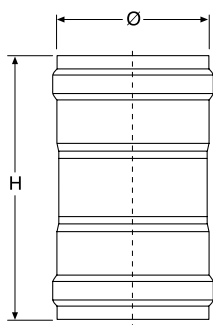

Ø	COD.	H	PCS
80	ALUMMA08	145	10

Ø	COD.	A	H	PCS
80	L316EXSCAFUM08	12	70	10

Ø	COD.	H	PCS
80	L316EXGASP08	60	10

Ø 60 a richiesta
Ø 60 on request

Colorazione nera a richiesta
Black color on request



ALUROSASI...

Rosone coprimuro interno in EPDM.

Internal wall plate in EPDM.



EXPL45A...

Collare a muro bianco con tassello.

White wall bracket with anchor bolt.



CLVPSIFONE

Sifone.

Siphon.

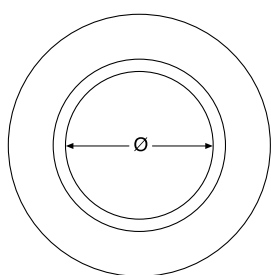

Ø	COD.	PCS
80	ALUROSASI08	10

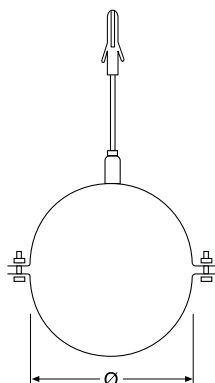

Ø	COD.	PCS
80	EXPL45A08	10

Ø	COD.	PCS
80	CLVPSIFONE	1



LUBGN

Lubrificante per guarnizione.

Lubricant for seal.

COD.	PCS
LUBGN	1

Ø 60 a richiesta
Ø 60 on request

Colorazione nera a richiesta
Black color on request